

Installation instructions Floor Drain Kvaser side/ Delling bottom

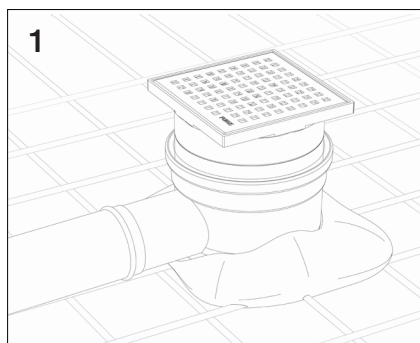

The floor gully must be mounted in a suitable and stable way for a horizontal installation and installed in a way that makes it possible to clean and remove the water trap.

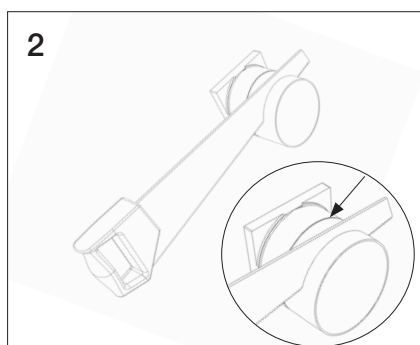

The upper part of the gully can be cut to 85-120mm. Keeping the cut below the marking on the top part. Clear the cut from degrees and such.

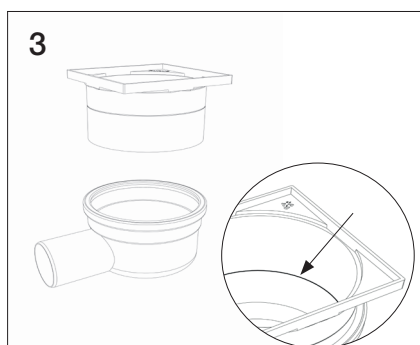

Lubricate the o-ring on the lower part properly with eg silicone paste.

Press the top part and socket together. Make sure the top ends up flat on the inside edge.

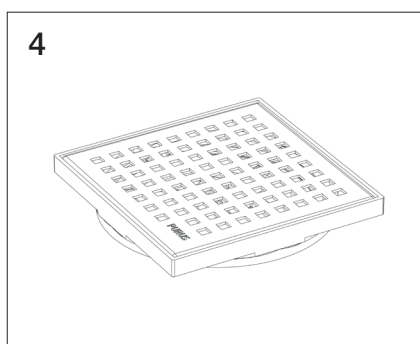

Pour concrete to the appropriate height, leaving room for the surface layer.

For additional language variations,
use QR code.

